

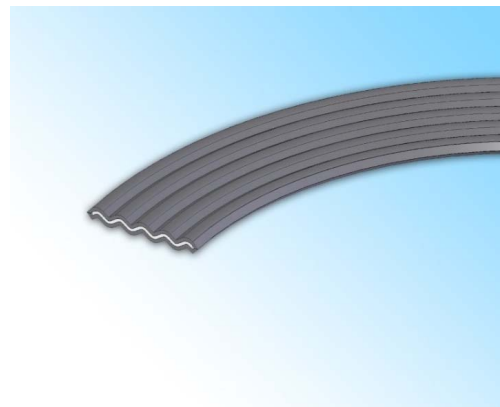

Klinger Maxigraph consists of a corrugated metallic core encapsulated by a graphite coating. Excellent microsealing performance from the graphite is combined with the strength of the metallic core.

- » Corrugations in the core develop high stress areas to produce a gasket with excellent leak-tightness at low bolt loads.
- » Corrugations prevent extrusion of the facing material
- » Uniform graphite density across the profile ensures excellent adaptability of the facing at the peaks to create a good seal even on worn flanges
- » Uniform graphite density across the profile ensures excellent adaptability of the facing at the peaks to create a good seal even on worn flanges
- » Excellent chemical resistance
- » Gasket core is totally encapsulated by the facing layer improving resistance to the process media
- » Good gasket rigidity, even for narrow sealing widths
- » Robust and easy to handle



APPLICATIONS:

- » Vessel applications with narrow seating widths
- » Pipeline applications
- » Suitable for a wide range of application temperatures and can be used in cryogenic applications

TYPICAL PROPERTIES:

- » Corrugated metallic core provides the gasket with improved handling characteristics over graphite laminates
- » Corrugations on the core create high stress regions to allow excellent sealing properties even with low gasket loads
- » Provides greater recovery properties than graphite laminate gaskets



TYPICAL SPECIFICATIONS:

- | | |
|---|------------------|
| » Material | 316L/Graphite |
| » Max. Temperature | 450°C |
| » Max. Pressure | 100 Bar |
| » Thickness | 2.5mm (standard) |
| * Other core materials available | |
| ** Can be manufactured with PTFE facing; Klinger Maxiflon | |

All information is based on years of experience in production and operation of sealing elements. However, in view of the wide variety of possible installation and operating conditions one cannot draw final conclusions in all application cases regarding the behaviour in gasket joint. The data may not, therefore, be used to support any warranty claims. This edition cancels all previous issues. Subject to change without notice.

Certified acc. to DIN EN ISO 9001:2015 Subject to technical alterations.
KLINGER Industrial Products India Pvt. Ltd. #6 Tarana, 1st Floor, GoodEarth Malhar, Kambipura, Kengeri, Bengaluru
560074, Karnataka, India. Tel +91 8618523021 / +91 80 2990 9572 / e-mail: info@klinger.in

www.klinger.in

